

PARKSIDE HALL · MONTGOMERY THEATER · SAN JOSE CIVIC

Under renovation.
Seating subject to change.

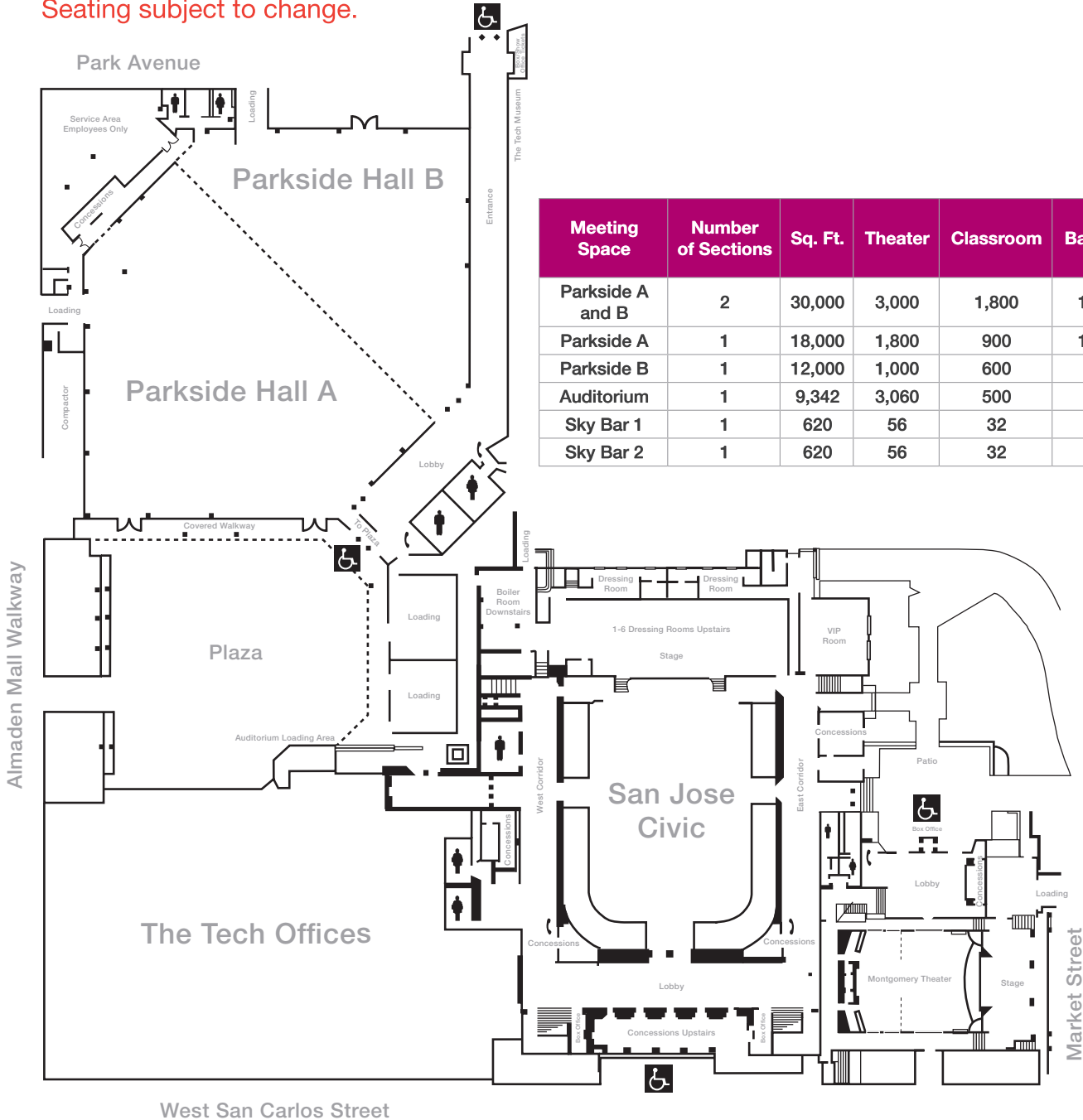

Meeting Space	Number of Sections	Sq. Ft.	Theater	Classroom	Banquet	8' x 10' Exhibit Booths
Parkside A and B	2	30,000	3,000	1,800	1,840	171
Parkside A	1	18,000	1,800	900	1,120	109
Parkside B	1	12,000	1,000	600	700	62
Auditorium	1	9,342	3,060	500	500	58
Sky Bar 1	1	620	56	32	30	-
Sky Bar 2	1	620	56	32	30	-

Location	Total Capacity	Main Floor Seating Capacity	Dress Circle Seating Capacity	Balcony Seating Capacity	Stage Size (WxH)	Stage Proscenium Opening (WxH)
San Jose Civic	2,890	1,064	632 (49 stage-obstructed)	1,194 (90 stage-obstructed)	112' x 35'	49'9" x 30'
Montgomery Theater	468	318	-	150	50' x 30'	26' x 14'

FACILITIES

SAN JOSE CIVIC MAIN LEVEL ~ CONCESSIONS & STAGE AREA

Under renovation.
Seating subject to change.

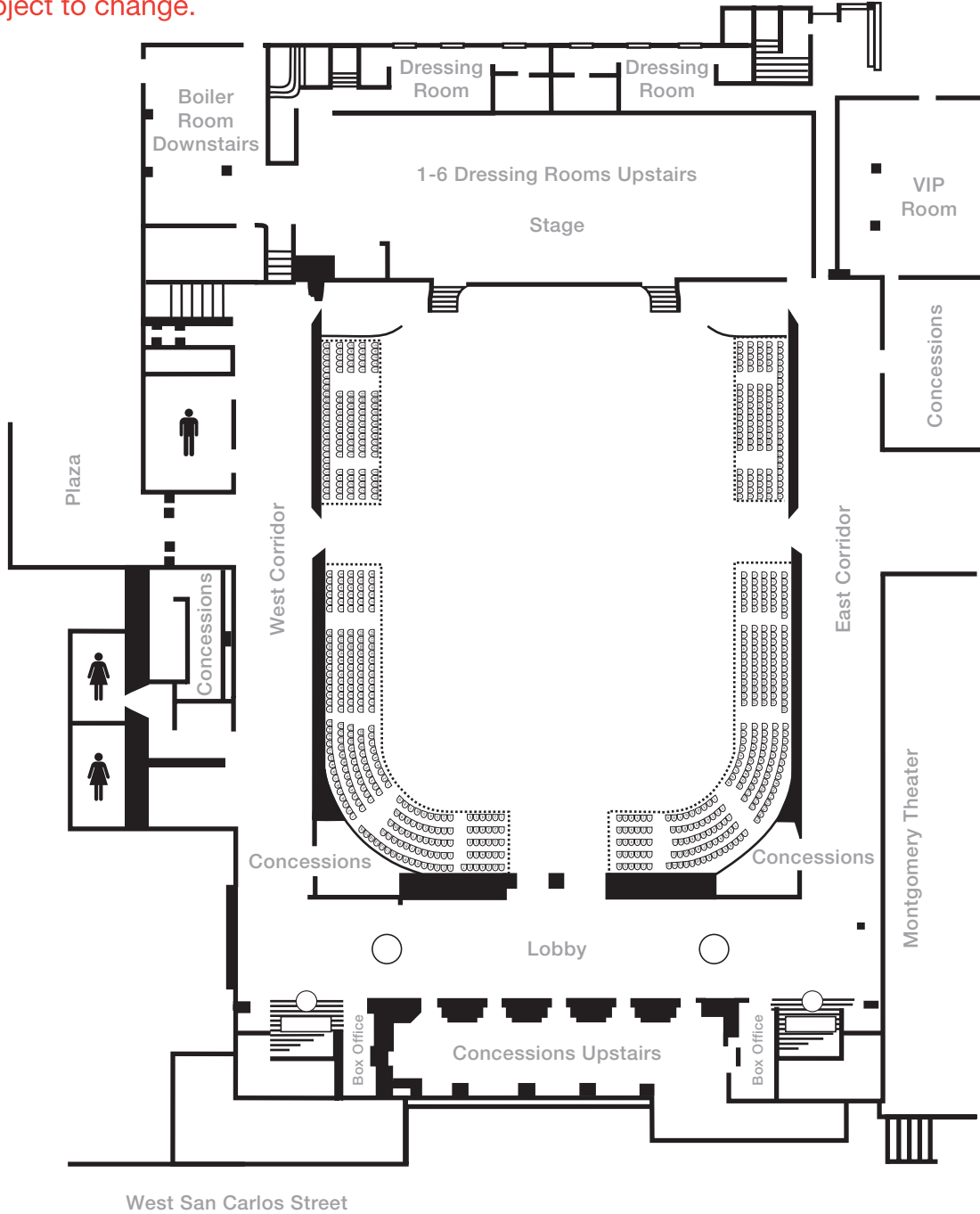

Location	Main Floor Dimensions	Ceiling	Total Capacity	Main Floor Seating Capacity	Dress Circle Seating Capacity	Balcony Seating Capacity	Banquet	Classroom	Proscenium Opening (W x H)	Stage Size (W x H)
San Jose Civic	79' x 118'	43'	2,890	1,064	632 (49 stage-obstructed)	1,194 (90 stage-obstructed)	500	500	49'9" x 30'	112' x 35'

*Room capacities do not include any ancillary equipment (i.e. staging, A/V, buffet tables, reception & registration area). Theater capacities do account for minimal staging setup.

FACILITIES

SAN JOSE CIVIC

SECOND LEVEL ~ CONCESSIONS & STAGE AREA

Under renovation.
Seating subject to change.

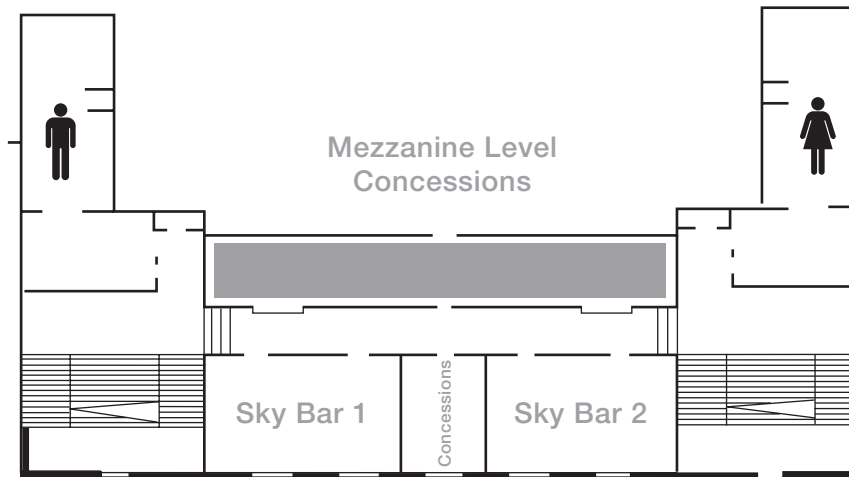
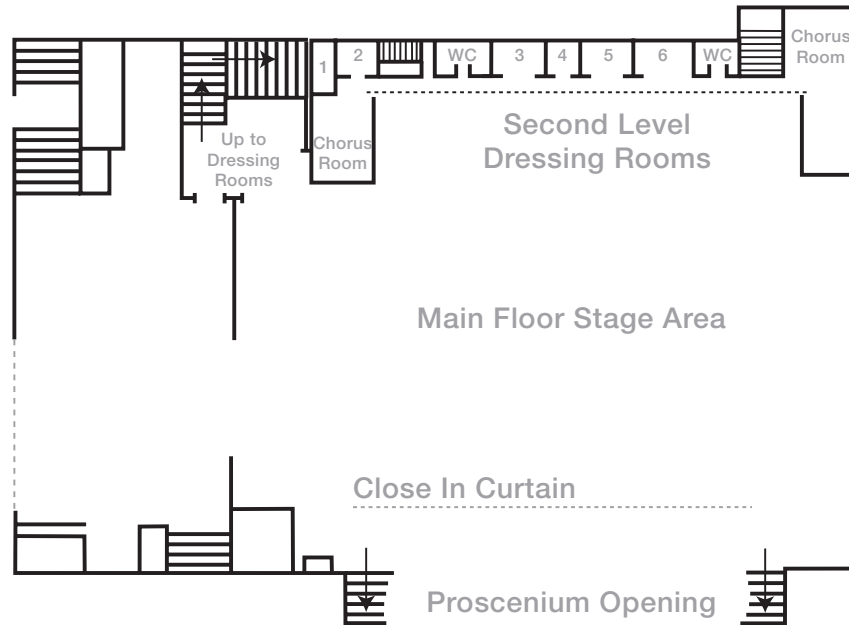

Location	Dimensions	Ceiling	Sq. Ft.	Theater	Classroom	Banquet
Sky Bar 1	19' x 33'	11'	620	56	32	30
Sky Bar 2	19' x 33'	11'	620	56	32	30

*Room capacities do not include any ancillary equipment (i.e. staging, A/V, buffet tables, reception & registration area). Theater capacities do account for minimal staging setup.

FACILITIES

SAN JOSE CIVIC SECOND LEVEL ~ CONCESSIONS

Under renovation.
Seating subject to change.



Location	Main Floor Dimensions	Ceiling	Sq. Ft.	Theater	Classroom	Banquet	Exhibit Booths	Floor Surface	Lights	Sound
Sky Bar 1	19' x 33'	11'	620	56	32	30	-	Carpet	Fixed	Portable
Sky Bar 2	19' x 33'	11'	620	56	32	30	-	Carpet	Fixed	Portable

*Room capacities do not include any ancillary equipment (i.e. staging, A/V, buffet tables, reception & registration area). Theater capacities do account for minimal staging setup.

FACILITIES

SAN JOSE CIVIC MAIN FLOOR & DRESS CIRCLE

Under renovation.
Seating subject to change.

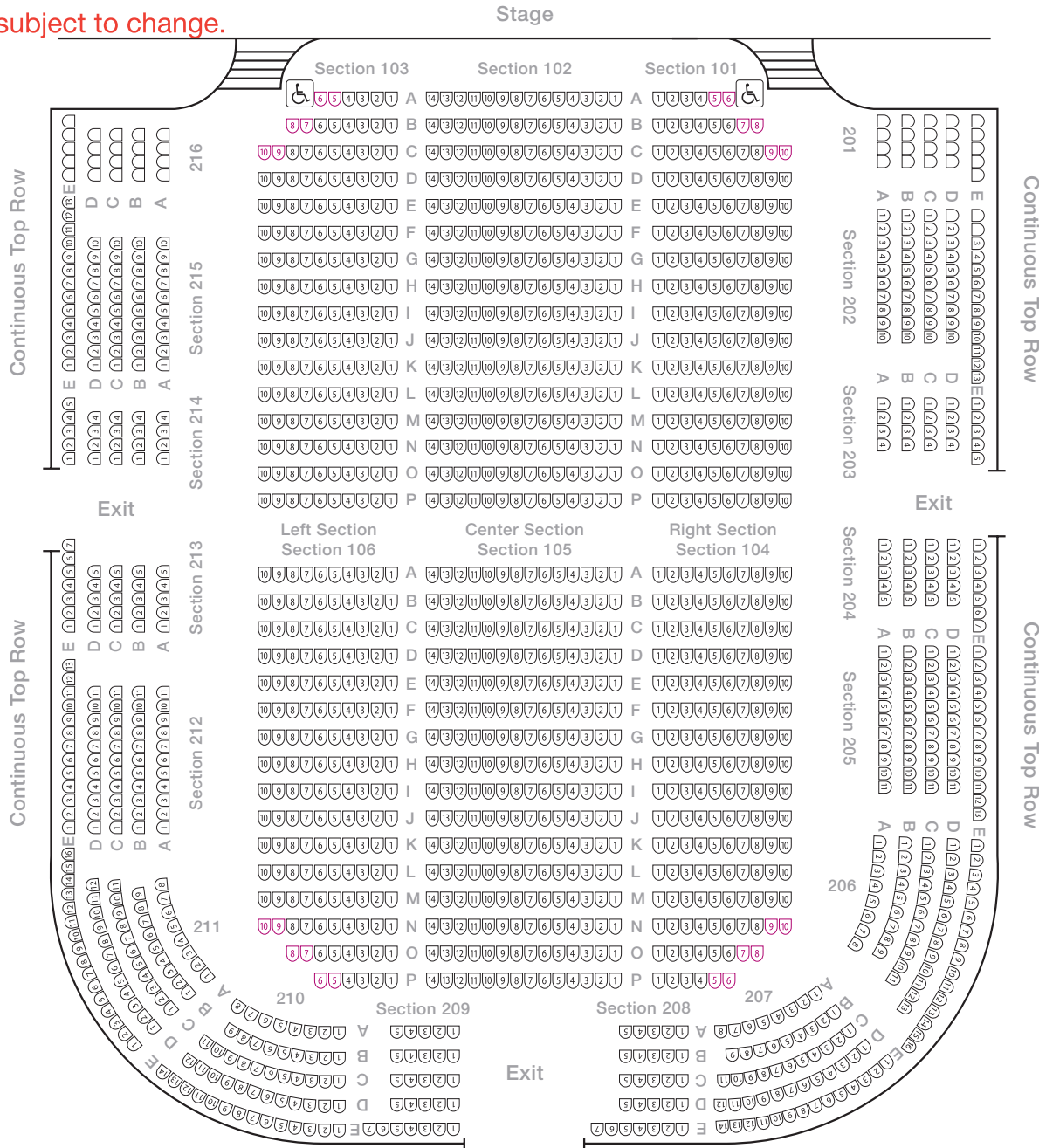

Integrated wheelchair accessible seating is available on the main floor only.
Section 101-106 are removable chairs.

KEY
ⓧ = ADA Seating

ADA seating is available in every price level

Location	Total Capacity	Main Floor Seating Capacity	Dress Circle Seating Capacity	Balcony Seating Capacity	Stage Size (WxH)	Stage Proscenium Opening (WxH)
San Jose Civic	2,890	1,064	632 (49 stage-obstructed)	1,194 (90 stage-obstructed)	112' x 35'	49'9" x 30'

FACILITIES

SAN JOSE CIVIC

BALCONY SEATING PLAN

□ = obstructed view

□ = obstructed view

Under renovation.
Seating subject to change.

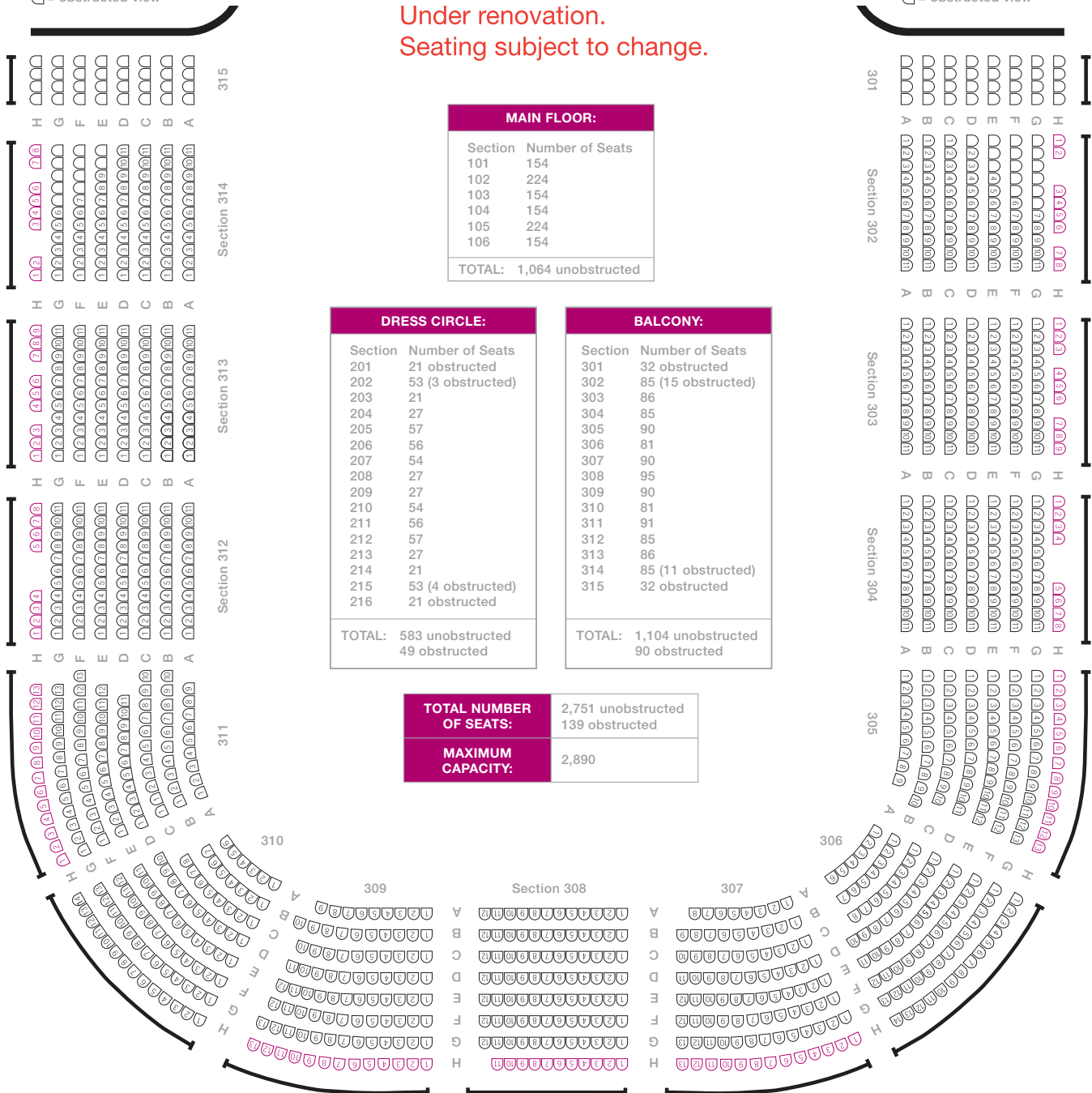

KEY
ⓧ = ADA Seating

ADA seating is available in every price level

Location	Total Capacity	Main Floor Seating Capacity	Dress Circle Seating Capacity	Balcony Seating Capacity	Stage Size (WxH)	Stage Proscenium Opening (WxH)
San Jose Civic	2,890	1,064	632 (49 stage-obstructed)	1,194 (90 stage-obstructed)	112' x 35'	49'9" x 30'

FACILITIES

SAN JOSE CIVIC ARENA SEATING PLAN

Under renovation.
Seating subject to change.

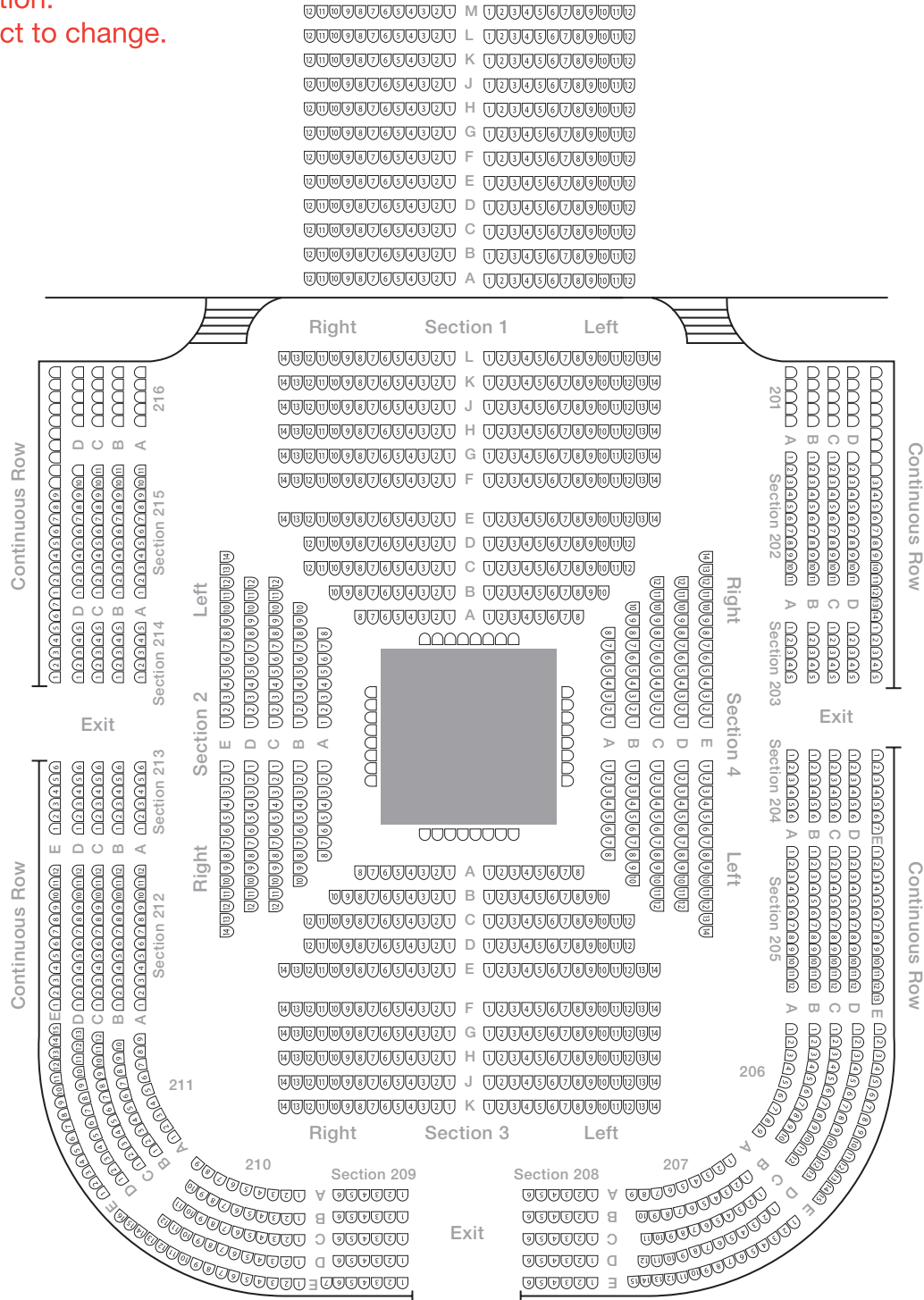

Location	Total Capacity	Main Floor Seating Capacity	Dress Circle Seating Capacity	Balcony Seating Capacity	Stage Size (WxH)	Stage Proscenium Opening (WxH)
San Jose Civic	2,890	1,064	632 (49 stage-obstructed)	1,194 (90 stage-obstructed)	112' x 35'	49'9" x 30'