

Dolce Hayes Mansion

200 Edenvale Avenue, San Jose, CA 95112 • 408-226-3200 • 866-981-3300
www.dolce-hayes-mansion-hotel.com



Fast Facts

- 12.6 miles away from the Airport
- 6.4 miles away from the Convention Center
- 214 total rooms including: 96 doubles, 77 kings, 17 queens, 17 parlor suites, 4 mansion suites, 2 junior suites, 1 presidential suite
- 3 diamond AAA rated hotel

Once a private estate, the Dolce Hayes Mansion is recognized for its excellent service, ambiance, amenities and technology features, which has resulted in the property to receiving many industry awards from leading magazines and organizations. Dedicated meeting planners, healthy dining options and superb meeting packages have helped the mansion earn a reputation of excellence, worthy of a Smart Meetings Platinum Award, a Corporate Meetings & Incentives Paragon Award and a Successful Meetings Pinnacle Award. Dolce Hayes Mansion has also received the IACC green star rating for its commitment to and follow-through on being a green property.

Amenities

- In-room wireless Internet access
- Health and fitness center
- Heated outdoor pool, indoor and outdoor jacuzzis, steam and dry sauna
- Full-service Concierge to assist you throughout your stay
- 24 hour self-service business center
- 2 onsite dining options
- In-house meeting tech/Audio-visual support
- Onsite catering
- Pet-friendly
- Room Service



Meeting Space

- 33,000 sq. ft. of total meeting space
- Largest meeting room is 6,600 sq. ft.
- 24 breakout meeting rooms
- Outdoor venues for up to 1,000 guests
- Onsite audio visual services
- Ergonomic chairs, hardtop work tables and white boards



Dolce Hayes Mansion

Ground Level Floor Plan

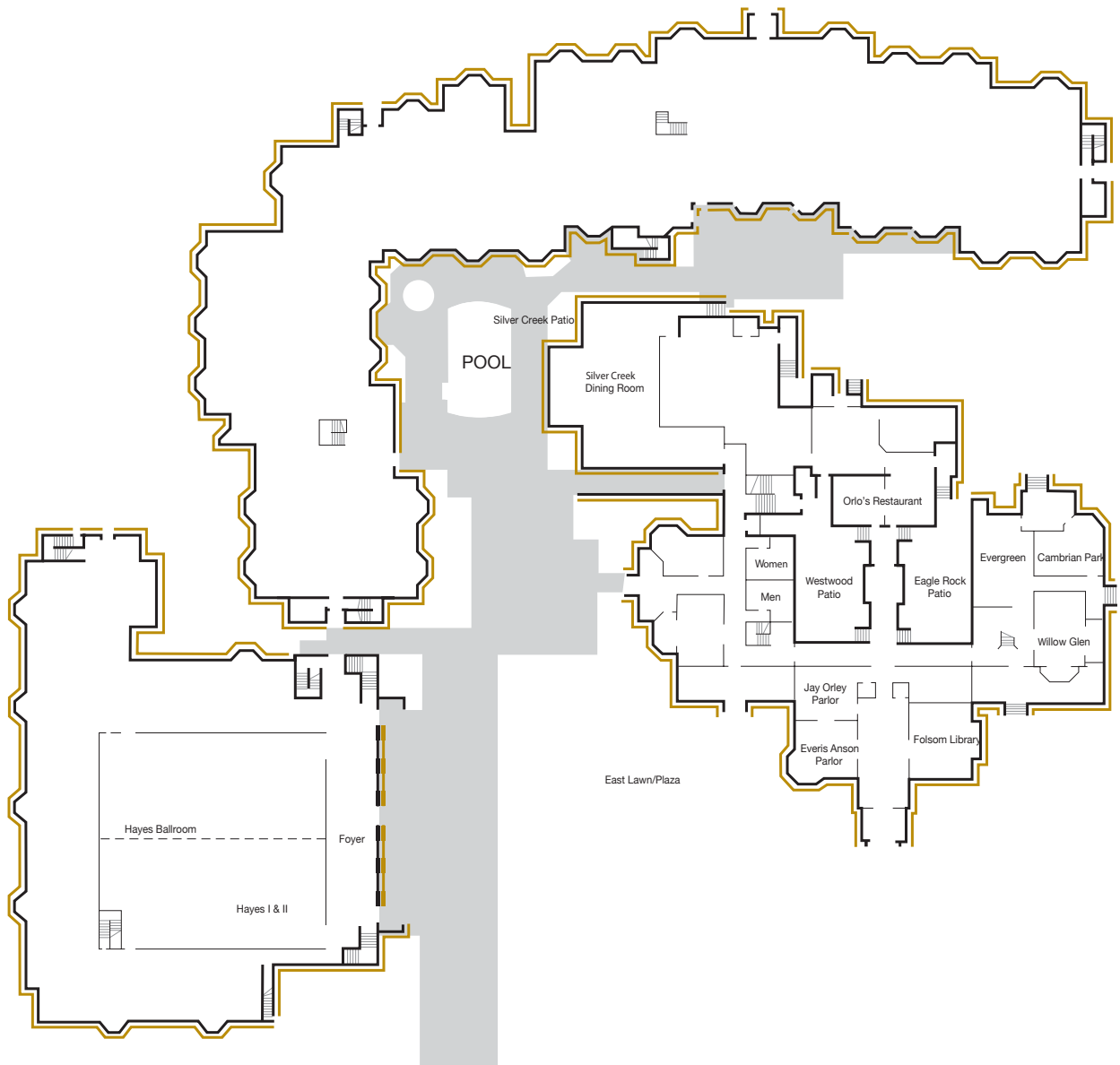

Dolce Hayes Mansion

Room Capacities



	Total Sq Ft	Room Size	Ceiling Ht	Classroom	Theater	Banquet 10	Reception	Conference	U-Shape	H-Square	10 x 10's
Almaden	720	22.00' x 33.00'	10	28	40	60	60	16	19	21	0
Alum Rock	610	18.00' x 34.00'	10	21	42	40	65	16	18	20	N/A
Berryessa	500	20.00' x 25.00'	10	24	54	40	53	16	17	22	N/A
Blossom Valley	480	18.00' x 27.00'	10	16	35	30	40	16	14	16	N/A
Branham	685	19.00' x 36.00'	10	27	24	40	70	16	18	20	N/A
Chynoweth	1520	32.00' x 49.00'	10	60	132	90	150	27	33	42	N/A
Eagle Rock	1885		10	30	65	50	100	24	24	28	N/A
East Lawn	20349		10	34	60	770	2110	26	24	30	N/A
Edenvale Room	3000	49.00' x 62.00'	11	130	270	200	280	38	44	59	N/A
Evergreen	320	17.00' x 23.00'	11	30	65	40	45	6	24	28	N/A
Everis Anson	480	21.00' x 23.00'	11	16	35	40	40	16	14	16	N/A
Folsom Library	525		10	12	30	30	55	10	11	14	N/A
Guadalupe	1100	24.00' x 45.00'	10	56	110	70	80	30	30	36	N/A
Hayes Ballroom	6600	86.00' x 70.00'	10	240	416	500	900	60	74	90	0
Hayes Ballroom I	3010	43.00' x 70.00'	20	130	208	240	280	48	48	60	0
Hayes Ballroom II	3010	43.00' x 70.00'	20	130	208	240	280	48	48	60	0
Jay Orley	380	19.00' x 20.00'	20	12	30	30	20	10	11	14	0
Live Oak	660	22.00' x 30.00'	11	24	56	40	50	16	17	22	0
LL Lobby	2090	22.00' x 95.00'	12	15	40	220	200	15	10	15	0
Madrone	660	22.00' x 30.00'	12	24	56	40	50	16	17	22	0
Monterey	1776	37.00' x 48.00'	12	70	156	120	160	24	29	37	0
Morgan Hill	1305	29.00' x 45.00'	12	38	100	80	120	24	32	27	0
Orlo's	1296		20								
Rose Garden	380	19.00' x 20.00'	10	12	30	20	30	10	11	14	N/A
San Jose	1100	24.00' x 45.00'	10	56	110	70	80	30	30	36	N/A
San Juan	638	22.00' x 29.00'	12	24	56	40	50	16	17	22	N/A
San Martin	1512	28.00' x 54.00'	10	57	132	100	150	30	35	42	N/A
Santa Teresa	285	12.00' x 19.00'	12	12	18	10	15	6	6	54	N/A
Silver Creek Dining Room	2000		10	40	60	160	215	24	22	28	N/A
Silver Creek Patio	3450		12	40	60	130	340	24	22	28	N/A
Westwood Patio	1885		12	38	121	70	150	18	24	27	N/A
Willow Glen	570	19.00' x 30.00'	11	24	54	50	60	16	17	22	N/A