

Hilton San Jose

300 Almaden Boulevard, San Jose, CA 95113 • 408-287-2100 • 800-HILTONS
www.sanjose.hilton.com



Fast Facts

- 3.9 miles away from the Airport
- Connected to the Convention Center
- 353 total rooms including: 8 executive suites, 5 hospitality suites, 1 presidential suite, 1 regency suite, 117 kings, 223 doubles
- 3 diamond AAA rated hotel

The Hilton San Jose is located in the Downtown core and is directly connected to the San Jose Convention Center for convention-goers' ease. All guestrooms offer the comfort and conveniences expected from a first class hotel as well as an option for Executive Level rooms with premiere services and upgraded amenities. Steps away from the hotel's front door is a Light Rail stop and it's also across the street from The Tech Museum, the San Jose Civic and the Center for the Performing Arts granting easy access to exhibits, concerts and Broadway shows.

Amenities

- Onsite dining and bar
- High-speed Internet
- Fitness center
- Pet friendly
- Secure parking



Meeting Space

- 19,000 sq. ft. of total meeting space
- Largest meeting room/ ballroom is 2,900 sq. ft.
- 14 total breakout meeting rooms
- Onsite catering
- Onsite audio visual services



Hilton San Jose

Meeting Rooms Floor Plan

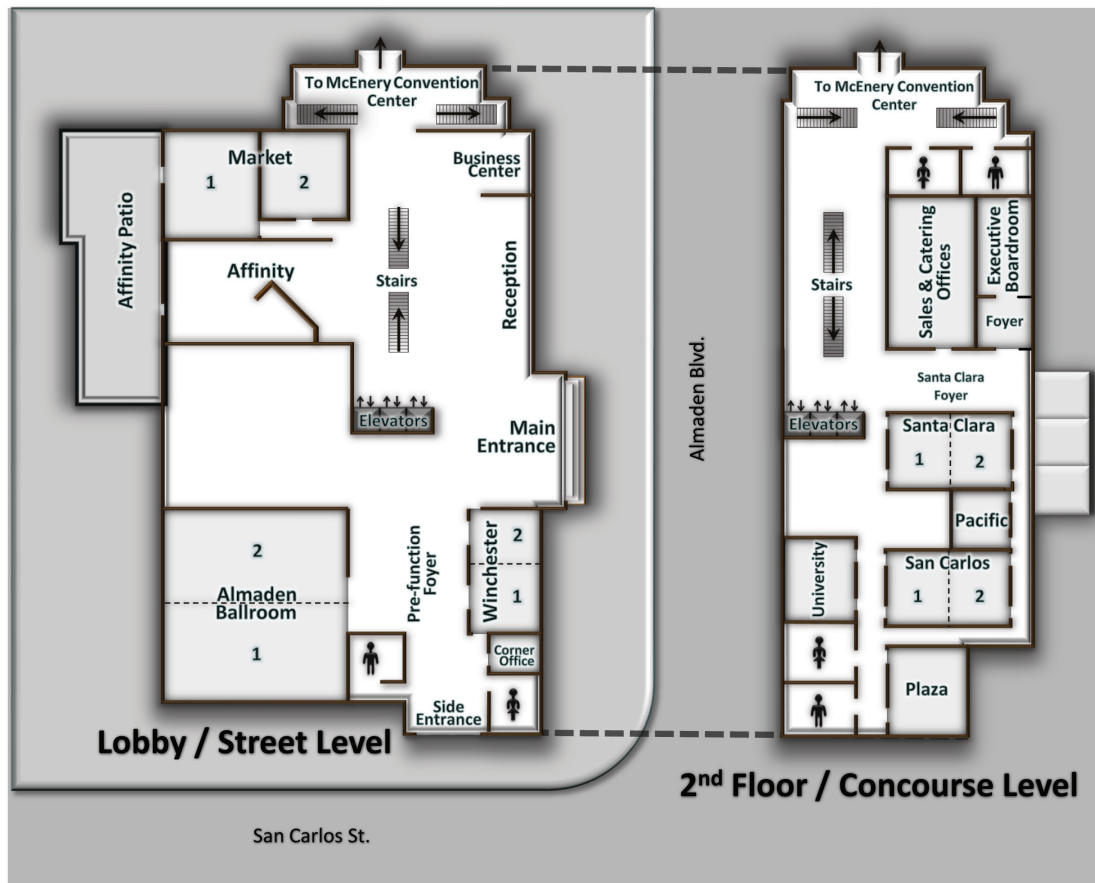

300 Almaden Boulevard, San Jose, California, United States 95110

Tel: 1-408-287-2100

visit: www.sanjose.hilton.com

Hilton San Jose

Meeting Rooms Dimensions

Room Name	Dimensions			Square Feet	Reception	Theater	Classroom	Rounds	Rounds with Dance Floor	Conference	U-Shape	Hollow Square
	L	W	H									
<i>Almaden Ballroom</i>	64'	90'	20'	2900	400	325	190	240	200	80+	80	100
<i>Almaden Foyer</i>	86'	45'	14'	1500	200	-	-	150	-	-	-	-
<i>Almaden One</i>	31'	45'	20'	1400	200	150	80	110	80	60	50	72
<i>Almaden Two</i>	32'	45'	20'	1440	200	150	80	110	80	60	50	72
<i>Santa Clara</i>	43'	29'	10+	1250	150	120	70	100	80	40	36	50
<i>Santa Clara Foyer</i>	74'	19'	14'	900	100	-	-	90	-	-	-	-
<i>Santa Clara I</i>	22'	29'	12'	640	50	60	30	50	30	28	20	28
<i>Santa Clara II</i>	21'	29'	10'	610	50	60	30	50	30	28	20	24
<i>San Carlos</i>	43'	29'	12'	1250	100	120	70	100	80	40	36	50
<i>San Carlos I</i>	22'	29'	12'	640	50	60	30	50	30	28	20	28
<i>San Carlos II</i>	21'	29'	12'	610	50	60	30	50	30	28	20	24
<i>Plaza Room</i>	31'	24'	12'	750	75	75	35	60	40	30	30	40
<i>University Room</i>	27'	26'	11'	700	60	60	30	50	30	28	20	36
<i>Pacific Room</i>	25'	16'	9'	304	30	30	20	30	20	15	16	28
<i>Executive Boardroom</i>	44'	14'	12'	615	-	-	-	-	-	14	-	-
<i>Market</i>	61'	28'		1775	150	110	72	130	110	50	40	50
<i>Market I</i>	34'	34'		1250	100	85	54	100	60	50	40	50
<i>Market II</i>	28'	27'		780	50	25	28	40	30	20	15	20
<i>Winchester</i>	50'	24'		1240	150	110	59	100	70	40	36	50
<i>Winchester II</i>	24'	23'		570	75	50	27	50	30	20	15	26
<i>Winchester I</i>	24"	27"		670	75	50	27	50	30	20	15	26
<i>City Patio</i>	74'	27'	-	1100	100	130	-	100	70	-	-	-
<i>SC CC Side Foyer</i>	20'	17'						30				
<i>Presidential Suite</i>	-	-	-	1064	75	35	25	50	-	20	18	24
<i>Regency Suite</i>	-	-	-	1064	60	-	-	-	-	10	-	-
<i>Hospitality Suites (5)</i>	-	-	-	950	60	30	20	30	-	16	14	16
<i>Executive Suite (8)</i>	-	-	-	950	40	-	-	20	-	10	-	-